



neelnox

LET
THERE
BE **DESIGN.**

FEATURES

- Premium 304 Grade Stainless Steel
- Solid Mount Construction
- Concealed Installation Hardware
- Solid End Cap provided for side opposite to the door for a seamless look



Small Rosette
(Dia 1 1/8")



Medium Rosette
(Dia 1 1/4")



Large Rosette
(Dia 1 1/2")



Single Door Handle
with Knob shown
with a medium Rosette

COLLECTION FORM

SINGLE DOOR HANDLE WITH KNOB

Model	Product	Finishes Available
FRM-SDKN <u>XX-XX</u>	Single Door Handle With Knob	Multiple finishes available. Over 23 finishes to choose from.

FINISHES			
Polished (-P)	Antique Copper (-ACOP)	Polished Gold (-PGLD)	
Brushed (-B)	Polished Brass (-PBRS)	Brushed Copper (-BCOP)	
Brushed Gold (-BGLD)	Matte White (-WHT)	Brushed Rose Gold (-BRGD)	
Matte Black (-BLK)	Brushed Modern Bronze (-BMBRZ)	Brushed Black (-BRBLK)	
Oil Rubbed Bronze (-ORB)	Glossy White (-GWHT)	Polished Black (-PBLK)	
Brushed Brass (-BBRS)	Polished Rose Gold (-PRGD)	Antique Nickel (-ANKL)	
Brushed Bronze (-BBRZ)	Unlacquered Brass (-UBRS)	Black Nickel (-NKBL)	
Antique Brass (-ABRS)	Polished Nickel (-PNKL)		

C2C	Small Rosette	Medium Rosette	Large Rosette
6"	FRM-SDKN6-SR	FRM-SDKN6-MR	FRM-SDKN6-LR
8"	FRM-SDKN8-SR	FRM-SDKN8-MR	FRM-SDKN8-LR
12"	FRM-SDKN12-SR	FRM-SDKN12-MR	FRM-SDKN12-LR
18"	FRM-SDKN18-SR	FRM-SDKN18-MR	FRM-SDKN18-LR
24"	FRM-SDKN24-SR	FRM-SDKN24-MR	FRM-SDKN24-LR
30"	FRM-SDKN30-SR	FRM-SDKN30-MR	FRM-SDKN30-LR

FRONT

SIDE

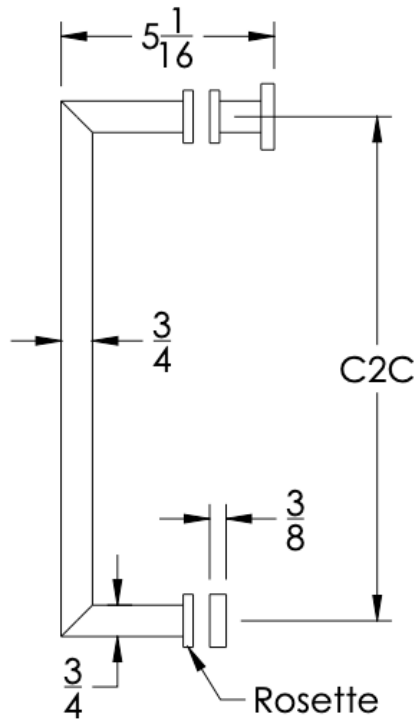
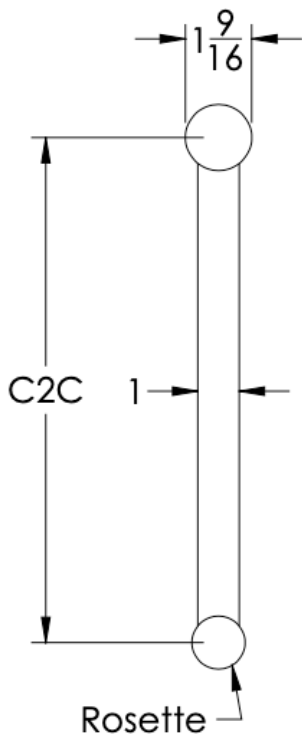

Installation Notes: Center to center hole drilling dimension are same as mentioned in column. Diameter of glass hole for installation is $\frac{1}{2}$ ".

Standard hardware supplied can accommodate glass thicknesses $\frac{1}{4}$ " to $\frac{1}{2}$ ". Please contact us for custom hardware in case glass thickness exceeds $\frac{1}{2}$ ".

 Small Rosette
(Dia $1 \frac{1}{8}$ "")

 Medium Rosette
(Dia $1 \frac{1}{4}$ "")

 Large Rosette
(Dia $1 \frac{1}{2}$ "")

 Small Dia $1 \frac{1}{8}$ "

 Medium Dia $1 \frac{1}{4}$ "

 Large Dia $1 \frac{1}{2}$ "

Dimensions in inches

NOTE: Dimensions subject to change without notice.